

PRELIMINARY

KS21 COMPACT REFERENCE SUBWOOFER



- High power compact 21" subwoofer
- Exceptional impact
- Improved efficiency
- Lightweight (49 kg / 108 lbs)
- Simple, fast, integral rigging
- Supported by LA4X and LA12X



ELECTRO-ACOUSTICS



KS21 is a compact reference subwoofer designed to extend the bandwidth of ARCS A15 and A10 systems. KS21 features one high excursion, direct radiating 21" transducer mounted in a bass-reflex tuned enclosure.

KS21 operates from 30 Hz to 60 Hz or 100 Hz to accommodate various coupling conditions and LF contour requirements. KS21 features L-Vents that substantially reduce turbulence and port noise at high levels while also increasing LF efficiency.

The KS21 frequency response is optimized to couple perfectly with both systems. KS21 features a two-point, integrated rigging system that is compatible with A15. Combinations of KS21 and A15 can be flown or stacked to form a full range line source. KS21 also integrates a threaded insert to enable pole-mount configurations of A15 or A10.

KS21 can be deployed in standard or cardioid configurations with dedicated presets, for flown and stacked deployment.



L-Vents laminar vented ports

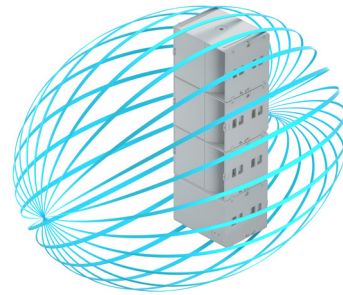

Rear SPL rejection (cardioid)

PHYSICAL

The KS21 enclosure is constructed of premium grade Baltic beech and birch plywood to ensure maximum acoustical and mechanical integrity. Bent wood technology combined with a thickness optimization process maximizes internal volume while attaining the low weight of 49 kg / 108 lb. The lightweight and robust design facilitates deployment and on-the-road manipulation.

KS21 integrates a patent pending two-point, captive rigging system that simplifies deployment and provides visual safety assessment. KS21 features ergonomic handles to ensure efficient handling, bottom ground runners and matching top tracks to secure stacking deployment and corner stops to protect side panels.

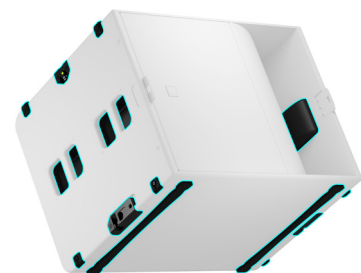

Integrated rigging with safety check; ergonomic handles; ground runners; corner stops.

APPLICATIONS AND BENEFITS

KS21 is the ideal companion for small to large events that require bandwidth extension and strong impact in a compact enclosure. KS21 is acoustically compatible with A15 and A10 and therefore is particularly suited to reinforce the low frequency contour of both systems.

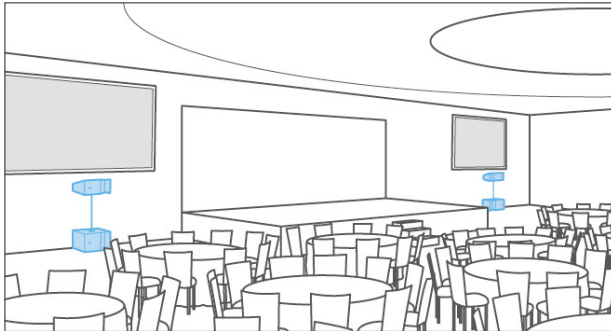



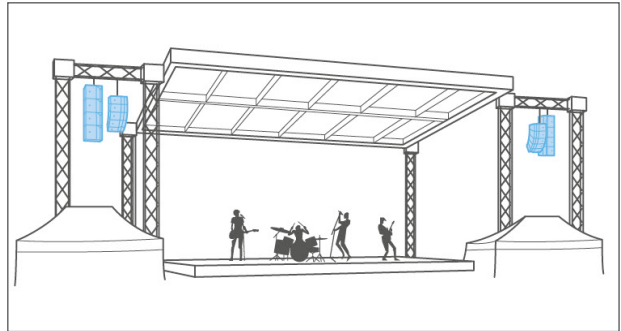



Corporate main system



Green field main system

RIGGING

KS21 can be groundstacked horizontally or stacked vertically on a KS21-CHARIOT. A15-BUMP supports flown vertical arrays in standard or cardioid arrangements. KS21 integrates a secure and easy-to-use rigging system that is compatible with A15 to facilitate any combination of flown or stacked deployment.

 Groundstacked / KS21-CHARIOT Up to 3 KS21 per KS21-CHARIOT	 A15-BUMP Up to 16 KS21	 A15-RIGBAR Up to 4 KS21
		

TRANSPORTATION ACCESSORIES

KS21-COV protective cover for 1 KS21	KS21-PLA removable front dolly for 1 KS21	KS21-CHARIOTCOV protective cover for 3 or 2 KS21 on KS21-CHARIOT	KS21-CHARIOT chariot for up to 3 KS28
			

AMPLIFIED CONTROLLER

LA4X: amplified controller with DSP



4 x 1000 W / 8 ohms or 4 ohms
4 inputs x 4 outputs architecture
Max 4 enclosures per amplified controller

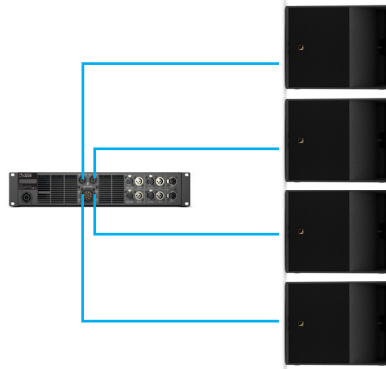

LA12X: amplified controller with DSP



4 x 2600 W / 4 ohms
4 inputs x 4 outputs architecture
Max 8 enclosures per amplified controller

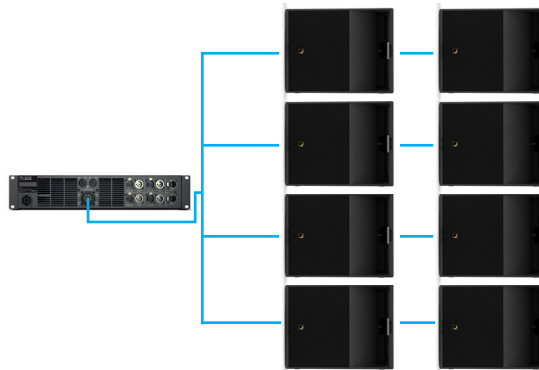

ASSOCIATED ENCLOSURES



A15 Focus



A15 Wide



A10 Focus



A10 Wide

SOFTWARE

SOUNDVISION: simulation software

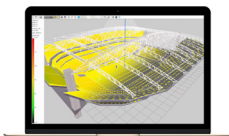

3D electro-acoustic & mechanical simulation software

LA Network Manager: control & monitoring software



Real-time control and monitoring up to 253 units
Multiple network topologies



SB15m



SB18 (i/m)



KS21



K1-SB



SB28

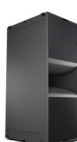

KS28

Subwoofers: a complete range for professional sound reinforcement

L-Acoustics subwoofers complement systems in applications where extended bandwidth is required.

All subs incorporate high excursion drivers, ultra-low vibration walls and laminar airflow L-Vents with a flared profile, resulting in dramatic reduction of port noise, maximized dynamics, power handling and an exceptional level of performance.